

MW 200

180 Watt max | 8 Ω | \varnothing 200 mm / 8"

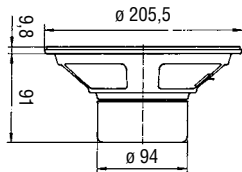

Potenza nominale	80 W	Re	6,6 Ω	D	165 mm
Impedenza nominale	8 Ω	Fs	36 Hz	Vas	65,4 dm³
Sensibilità (1W/1m)	93 dB	Qms	2,13	Bxl	7,3 Wb/m
\varnothing bobina mobile	32 mm	Qes	0,52	Xmax	1,75 mm
Altezza traferro	6 mm	Qts	0,42	η_o	0,59 %
Fori di fissaggio	4 \varnothing 5,5 / \varnothing 194	Mms	18,2 g	Le	0,58 mH
Foro pannello	185 mm	Cms	1,05 mm/N	Peso	1,5 Kg

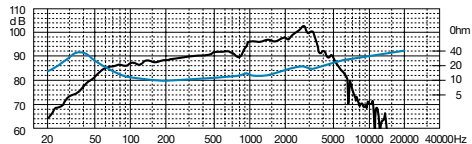

WOOFER

Membrana in cellulosa smorzata, sospensione in gomma, magneti schermato

Doped paper cone, rubber surround, magnetic shielding

