

## CZ 120

100 Watt max

4 Ω

Ø 120 mm / 4,5"

### COASSIALI

2 Vie coassiali, membrana woofer in cellulosa smorzata, tweeter in neodimio, con molle di fissaggio

2 Way coax, doped paper cone, neodymium tweeter, with fixing springs

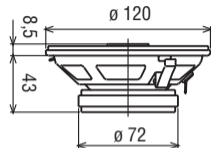

Potenza nominale **40 W**

Impedenza nominale **4 Ω**

Sensibilità (1W/1m) **90 dB**

Ø bobina mobile **25 mm**

Altezza traferro **4 mm**

Fori di fissaggio

Foro pannello **109 mm**

Re **3,5 Ω**

Fs **131 Hz**

Qms **6,74**

Qes **1,76**

Qts **1,40**

Mms **4,7 g**

Cms **0,32 mm/N**

D **100 mm**

Vas **2,72 dm<sup>3</sup>**

B×l **2,76 Wb/m**

Xmax **1,1 mm**

η°

Le

Peso **0,48 Kg**