

MM1-MM1T

D:	28 mm
Re:	3 Ohm
Fs:	1050 Hz
Qt:	0.98
Qm :	3.15
Bl:	1.49 N/A
Le:	0,4 mH
Freq-resp:	1.3-22 kHz
Pmax:	30 W 1,5 kHz
dB Spl:	91.5

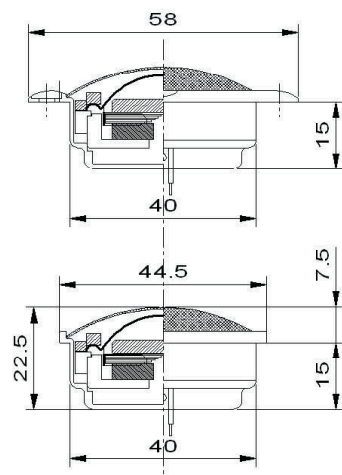

MM1 PHASE/IMPEDANCE

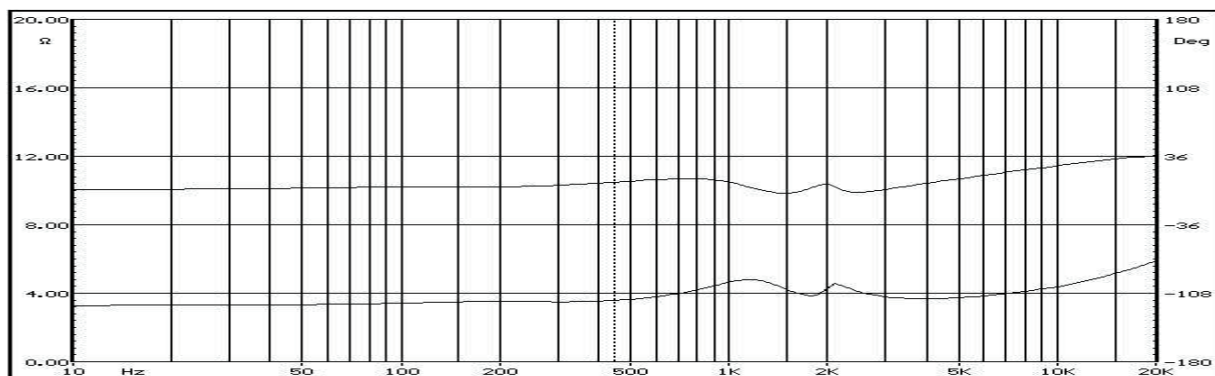

FREQUENCY RESPONSE

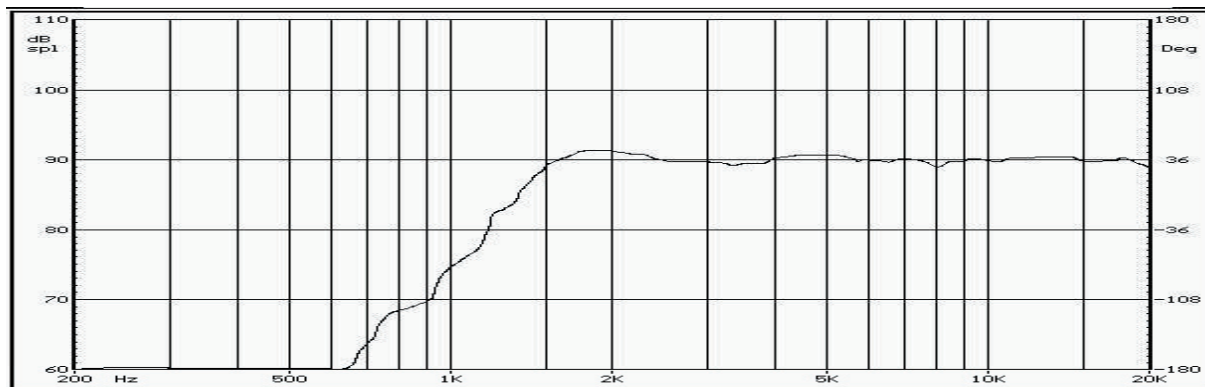

TECHNICAL FEATURES

- DOME: 28 mm diameter, silk.
- VOICE COIL: OFC copper on aluminium former (Ø 25 mm). Ferrofluid cooled.
- MAGNET: High temperature stable Neodimium , magnetized with an internal procedure.
- BAFFLE: 58mm diameter, single block of aluminium, double loading chamber.

With its rear loading chamber, this tweeter features a low frequency of resonance, which, together with the 60 mm baffle, allows the component to start working from lower frequencies than usual, and, thanks to the 1" silk dome, to reach the highest frequencies without problems. The out of axis response is optimised, making the dispersion asymmetric and pointing at its maximum with a red spot on the side of the chassis. Available in black or silver, with or without the baffle. No matter which version, this is the expression of our skills and know how.

Due to the continue increase of the performances, parameters are subject to change without notice
Laboratorio Audio s.n.c. Via del Progresso 26/A Castalgomberto (VI) AD audio development.

MM1S-MM1TS

D:	28 mm
Re:	3 Ohm
Fs:	560 Hz
Qt:	0.98
Qm :	1.91
Bl:	0.8 N/A
Le:	0,31 mH
Freq-resp:	1.2-22 kHz
Pmax:	25 W 1,5 kHz
dB Spl:	90

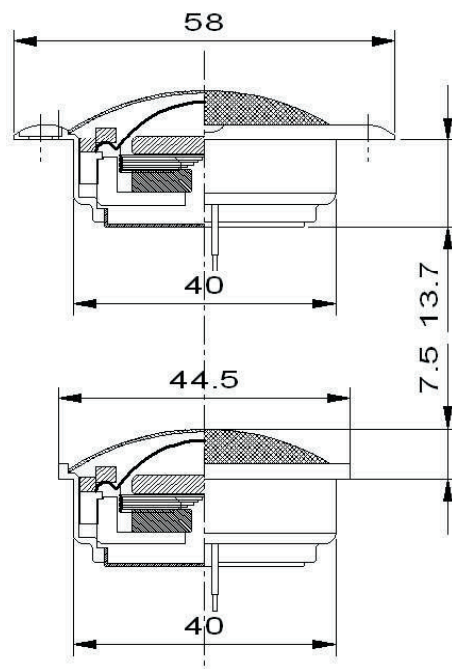

MM1S IMPEDANCE

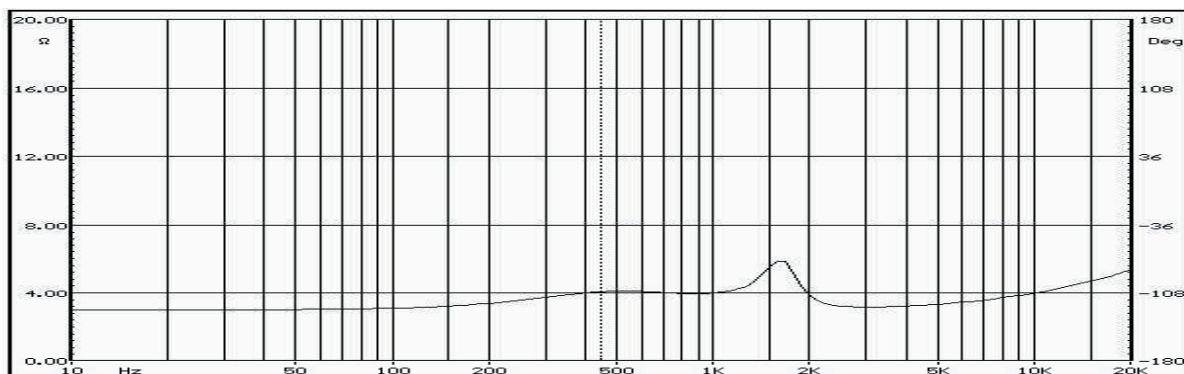

FREQUENCY RESPONSE

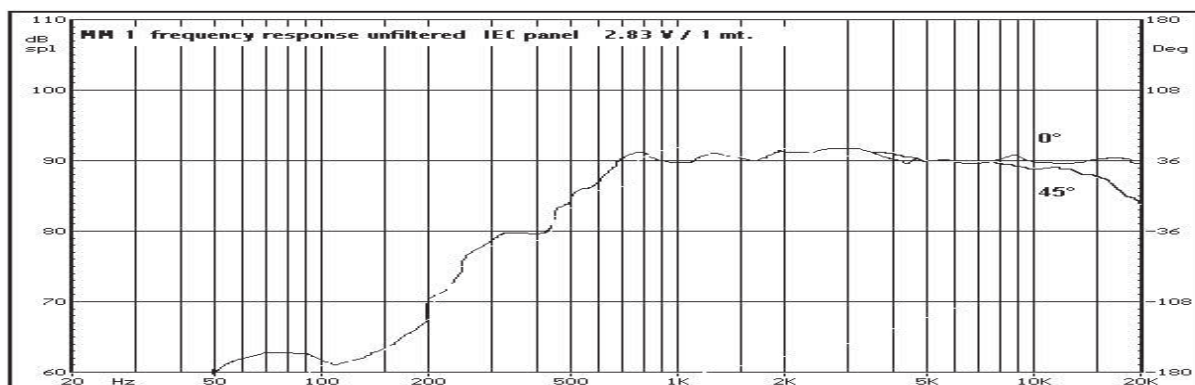

TECHNICAL FEATURES

- DOME: 28 mm diameter, silk.
- VOICE COIL: OFC copper on aluminium former (Ø 25 mm). No ferrofluid cooled.
- MAGNET: High temperature stable Neodimium, magnetized with an internal procedure.
- BAFFLE: 58mm diameter, single block of aluminium, double loading chamber.

This tweeter is absolutely innovative and one of a kind. It is a band pass with opened rear loading chamber. Such a system grants the maximum sound nature and extreme extension to the medium range. This tweeter does not have ferrofluid, and such feature creates no mechanical connection to the voice coil. It confers high speed, and the damping is created from the loadings and from the type of suspension, which produce a warm and very realistic sound.

Due to the continue increase of the performances, parameters are subject to change without notice
Laboratorio Audio s.n.c. Via del Progresso 26/A Castelgomberto (VI) AD audio development.

T 1FR

D:	31 mm
Re:	3.7 Ohm
Fs:	---- Hz
Qt:	---
Qm :	---
Bl:	--- N/A
Le:	--- mH
Freq-resp:	4-23 kHz
Pmax:	30 W 1,5 kHz
dB Spl:	88

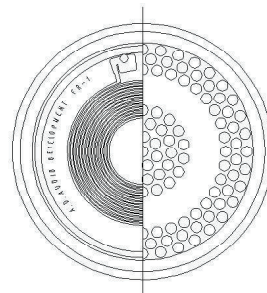
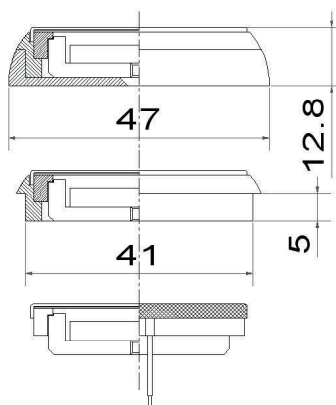

T1FR IMPEDANCE

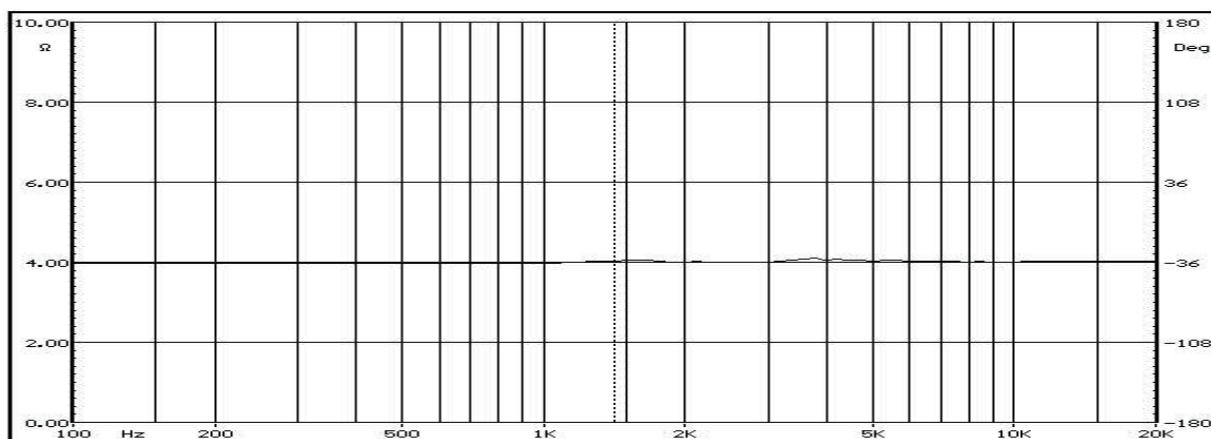

T1FR FREQUENCY RESPONSE

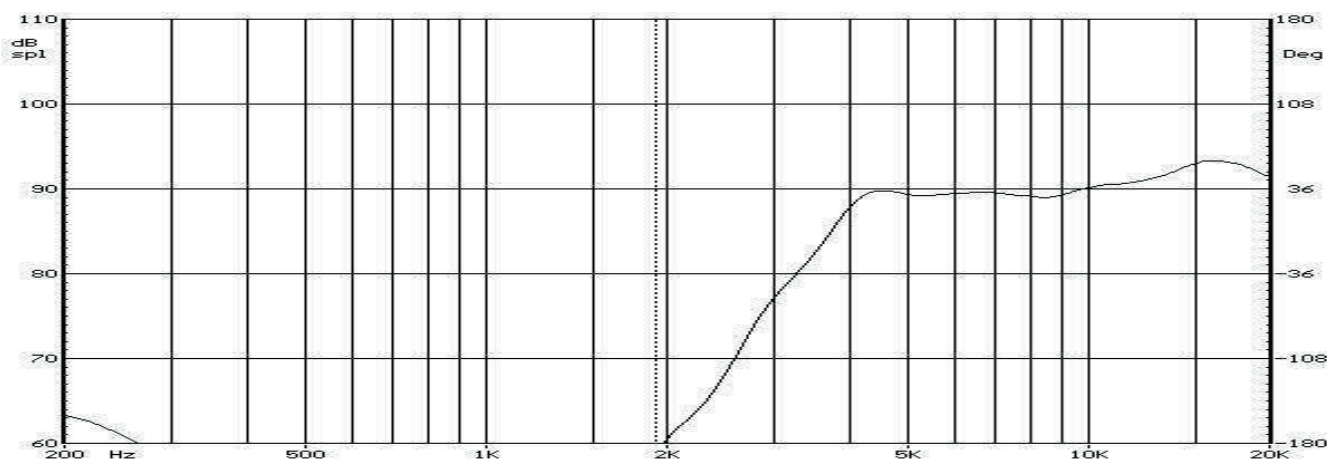

TECHNICAL FEATURES

- MOUNTING SYSTEM: The flatness of the component allows the external or flush mounting.

The AD supertweeter. Even in a component usually dedicated to the extreme high frequencies, we have put our fingerprints, developing an unconventional round ribbon tweeter which, with the support of a simple cap, presents itself with a flat response from 4 to 25 kHz.

The mounting depth of less than 7 mm and the high power handling are other features of this component.

Due to the continue increase in the performances, the parameters are subject to change without notice.
Laboratorio Audio s.n.c. Via del Progresso 26/A Castelgomberto (VI) AD audio development

T 10

D:	26 mm
Re:	3 Ohm
Fs:	1730 Hz
Qt:	0.99
Qm :	1.78
Bl:	1.41 N/A
Le:	0,32 mH
Freq-resp:	2.2-20 kHz
Pmax:	30 W 1,5 kHz
dB Spl:	90

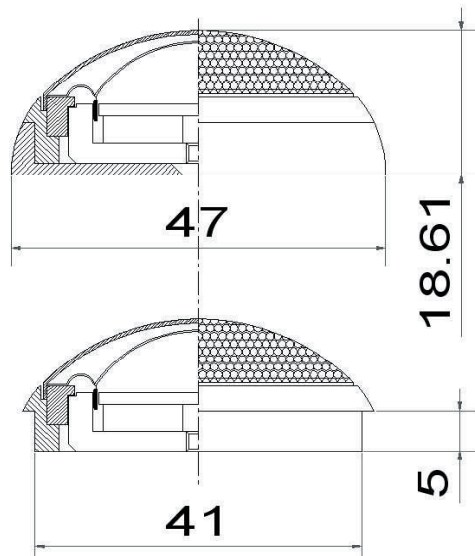

T 10 IMPEDANCE

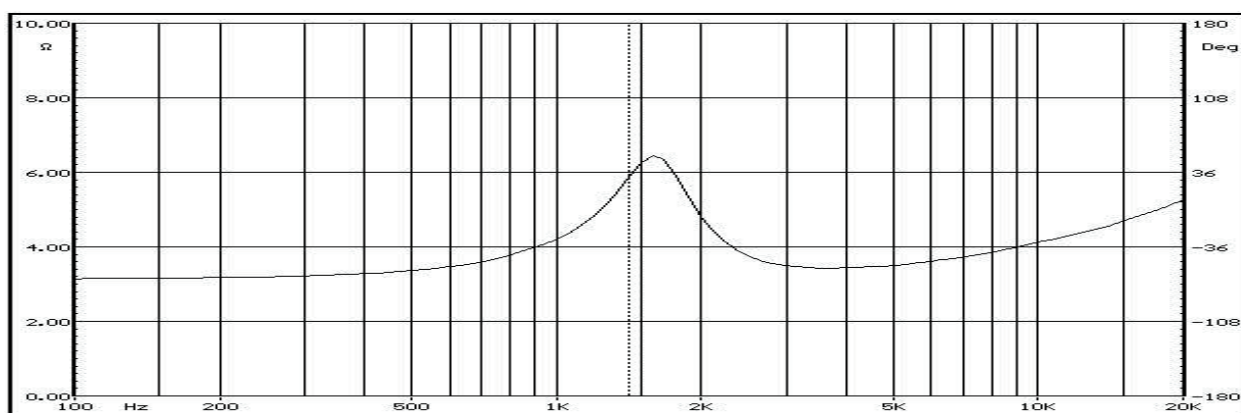

T 10 FREQUENCY RESPONSE

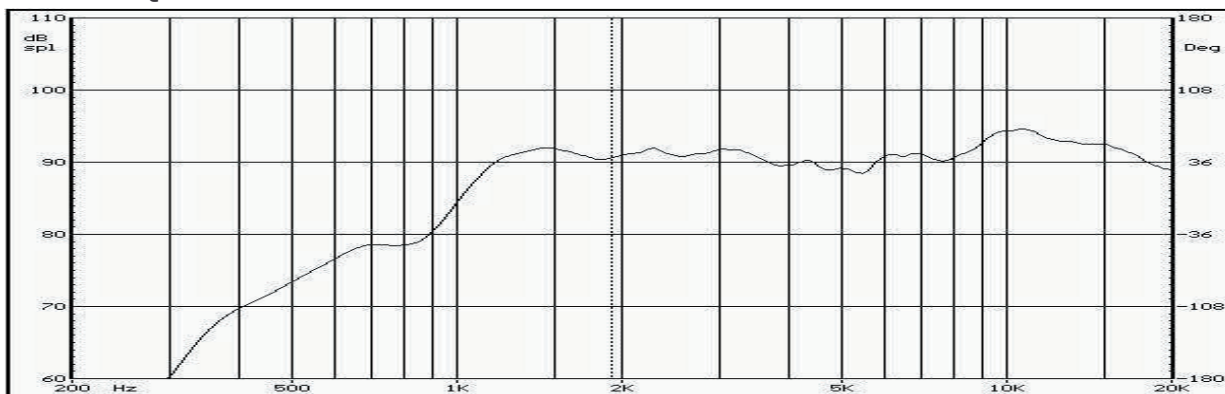

TECHNICAL FEATURES

- DOME: 26 mm diameter silk dome.
- VOICE COIL: Pure copper on aluminum former (Ø 25 mm)
- MAGNETIC CIRCUITATION: High thermal stability Neodimium, magnetized with an internal procedure.
- MOUNTING SYSTEM: Tri-mount with adaptors, for external, internal or baffle usage.

Dedicated to the "Ten" line, this tweeter is an all purpose item. Thanks to the dome shape and the careful evaluation of weights, its response is more aggressive and quick, ready for modern music.

Due to the continue increase in the performances, the parameters are subject to change without notice.
Laboratorio Audio s.n.c. Via del Progresso 26/A Castelgomberto (VI) AD audio development.

T 19

D:	22 mm
Re:	3.8 Ohm
Fs:	1650 Hz
Qt:	0.93
Qm :	1.39
Bl:	1.4N/A
Le:	0,25 mH
Freq-resp:	3.3-20 kHz
Pmax:	20 W 1,5 kHz
dB Spl:	87

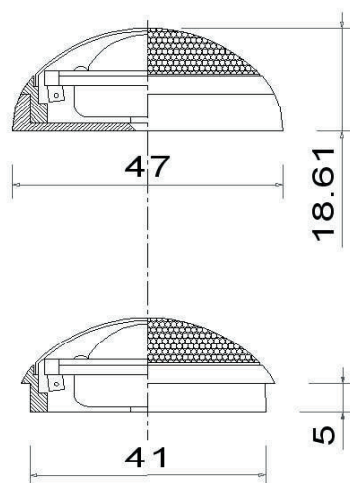

T19 IMPEDANCE

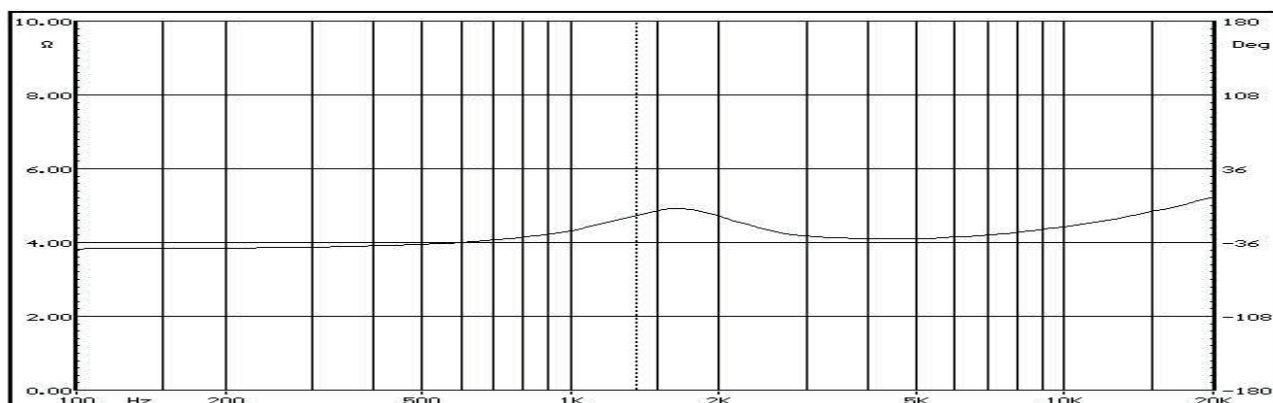

T19 FREQUENCY RESPONSE

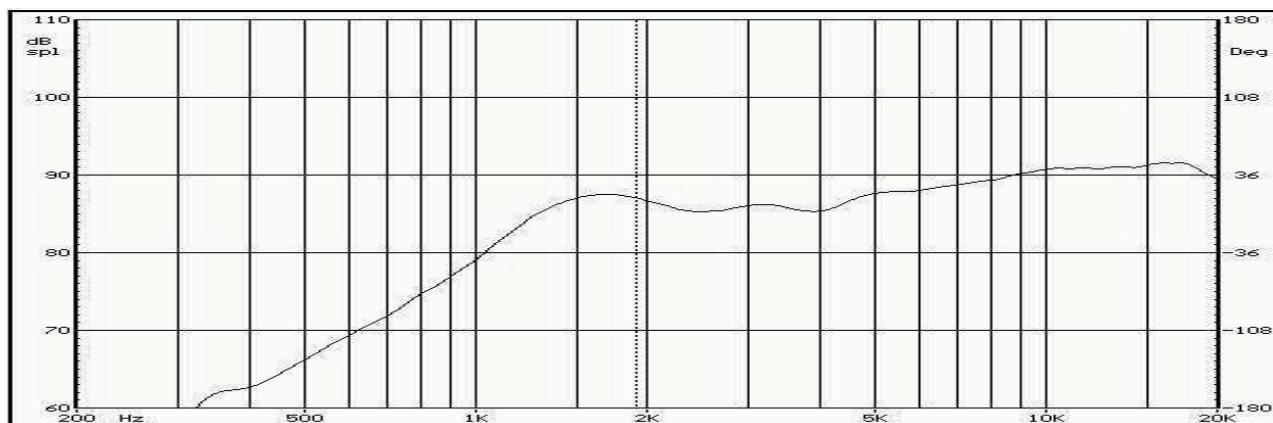

TECHNICAL FEATURES

- DOME: 22mm diameter silk dome.
- VOICE COIL: Copper on aluminum former (Ø 19 mm)
- MAGNETIC CIRCUITATION: High thermal stability neodymium, Ferrofluid cooled.
- MOUNTING SYSTEM: Inserted in the same case of the more precious models.

This tweeter is used in the "Trend" systems and coaxials' silk dome tweeter is the only ¾" in our catalogue. Clear and musical, it wasn't studied to reach the highest peaks of power handling, but to give a high class performance in the high frequencies, even in an Entry Level product.

Due to the continue research and development, these information are subject to change without notice.
Laboratorio Audio s.n.c. Via del Progresso 26/A Castelgomberto (VI) AD audio development.

T 100

D:	28 mm
Re:	3 Ohm
Fs:	1470 Hz
Qt:	0.81
Qm :	1.37
Bl:	1.45N/A
Le:	0,4 mH
Freq-resp:	1.8-20 KHz
Pmax:	25 W 1,5 kHz
dB Spl:	89

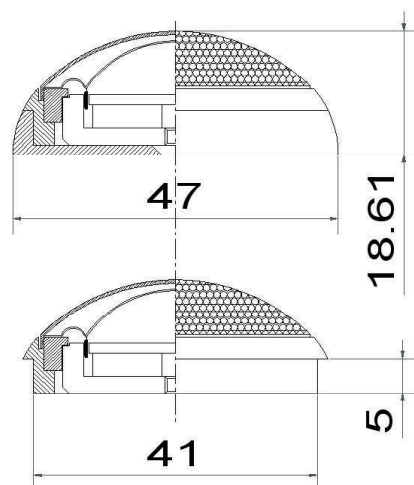

T100 IMPEDANCE

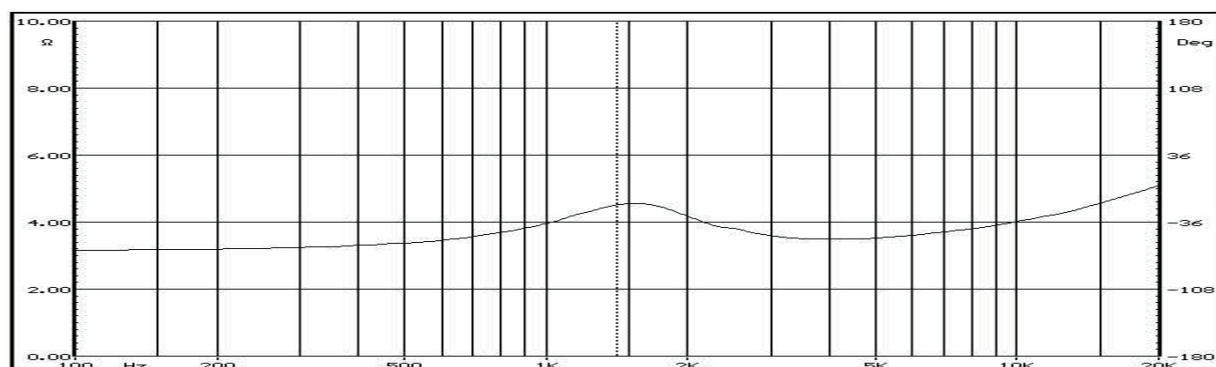

T100 FREQUENCY RESPONSE

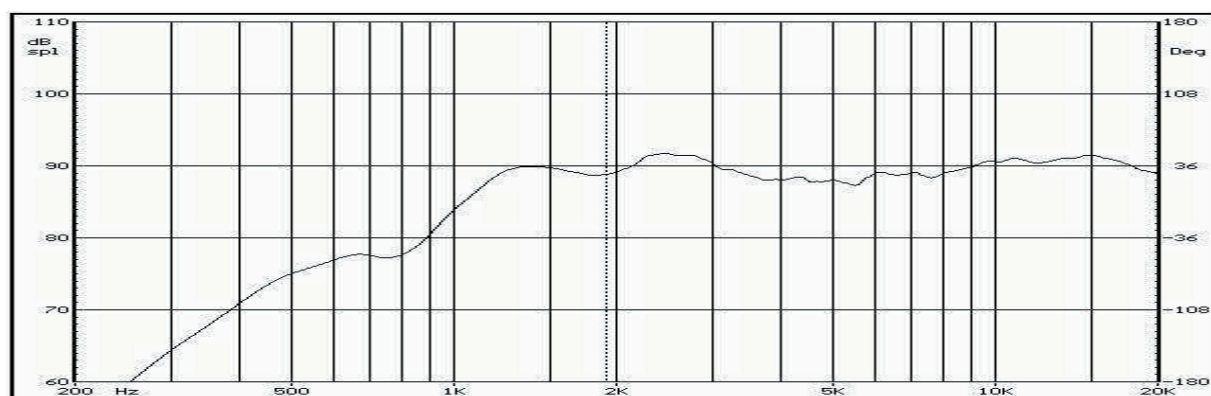

TECHNICAL FEATURES

- DOME: 28 mm diameter silk dome.
- VOICE COIL: Pure copper on aluminum former (Ø 25 mm). Ferrofluid cooled
- MAGNETIC CIRCUITATION: High thermal stability Neodimium, magnetized with an internal procedure.
- MOUNTING SYSTEM: Tri-mount with adaptors, for external, internal or baffle usage.

This tweeter inherits the features that made its father one of the most reckoned 1" silk dome in the market. High quality Neodimium, Ferrofluid, small dimensions, these are some first appearing features. The magnetic circuit, cornerstone of the AD designs, and the power handling, are others of its features, making this component the right solution for three way systems of no comprises, as well as for classical two way systems.

Phase and impedance curves are measured after 20 hours burn-in at 10 W RMS, so are the T / S parameters.
Due to the continue research and development, these information are subject to change without notice.
Laboratorio Audio s.n.c. Via del Progresso 26/A Castelgomberto (VI) AD audio development.

T100F NEO

D:	27 mm
Re:	3 Ohm
Fs:	927 Hz
Qt:	0.6
Qm :	1.77
Bl:	1.84 N/A
Le:	0,04 mH
Freq-resp:	1.5-20 kHz
Pmax:	30 W 1,5 kHz
dB Spl:	90

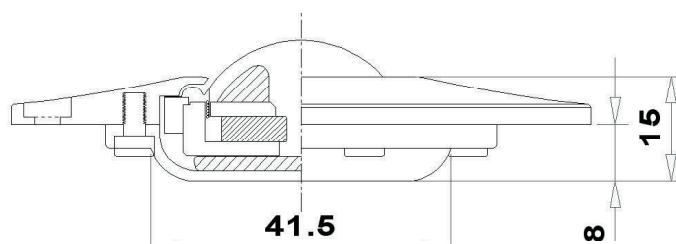

T100F NEO IMPEDENCE

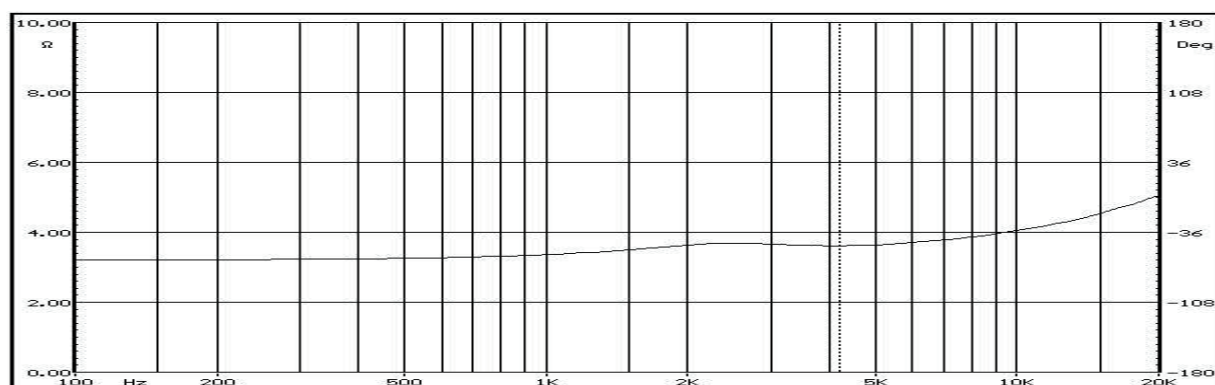

T100F NEO FREQUENCY RESPONSE

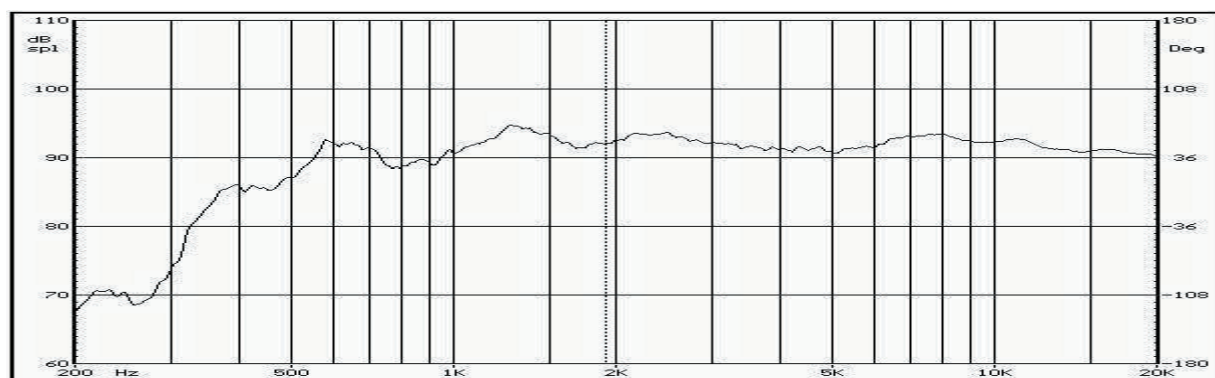

TECHNICAL FEATURES

- DOME: 27mm diameter silk dome.
- VOICE COIL: Pure copper on aluminum former (Ø 25 mm). No ferrofluid.
- MAGNET: Neodimium.
- BAFFLE: 91mm diameter, with a shape studied to increase the linearization. Double tuned chamber - band pass

Directly from home hi-end, this tweeter has a resonance frequency low enough to cross the bass frequency transducers without problems, building no compromise two way systems. Silk dome, neodimium magnet, high power handling are some of the features of this component, suggested in all those systems where quality rules, in particular over the scenic reconstruction of the musical reproduction.

Due to the continue research and development, these information are subject to change without notice.

Laboratorio Audio s.n.c. Via del Progresso 26/A Castalgomberto (VI) AD audio development.

T 100 F

D:	27 mm
Re:	3 Ohm
Fs:	980 Hz
Qt:	0.54
Qm :	1.2
Bl:	1.84 N/A
Le:	0,4 mH
Freq-resp:	1.5-20 kHz
Pmax:	30 W 1,5 kHz
dB Spl:	90.5

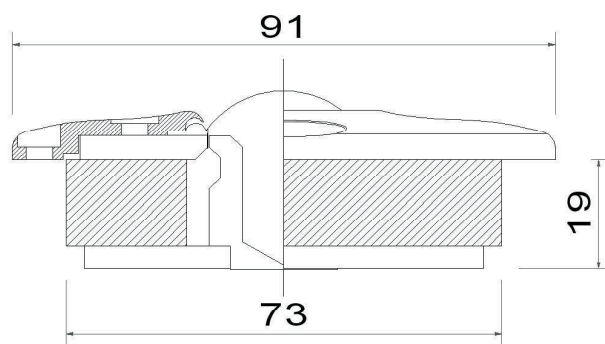

T100 F IMPEDANCE

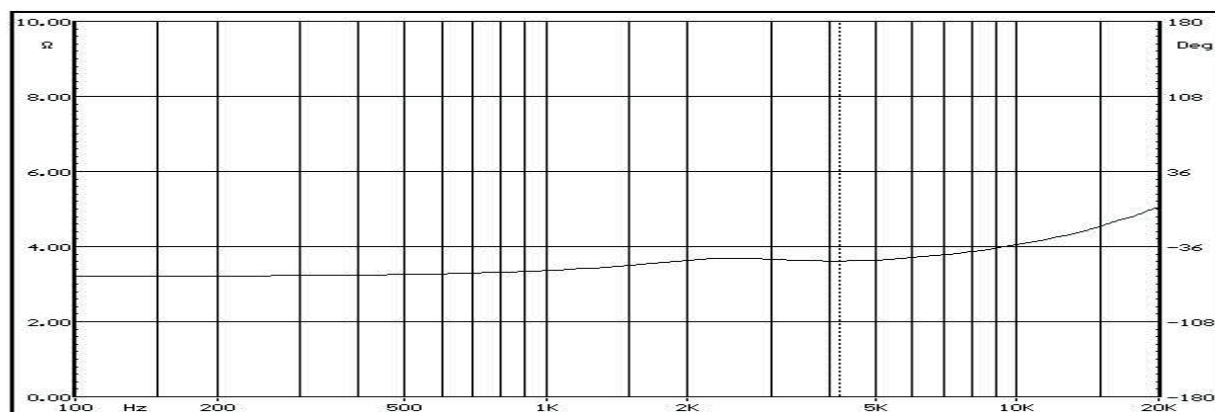

T100 F FREQUENCY RESPONSE

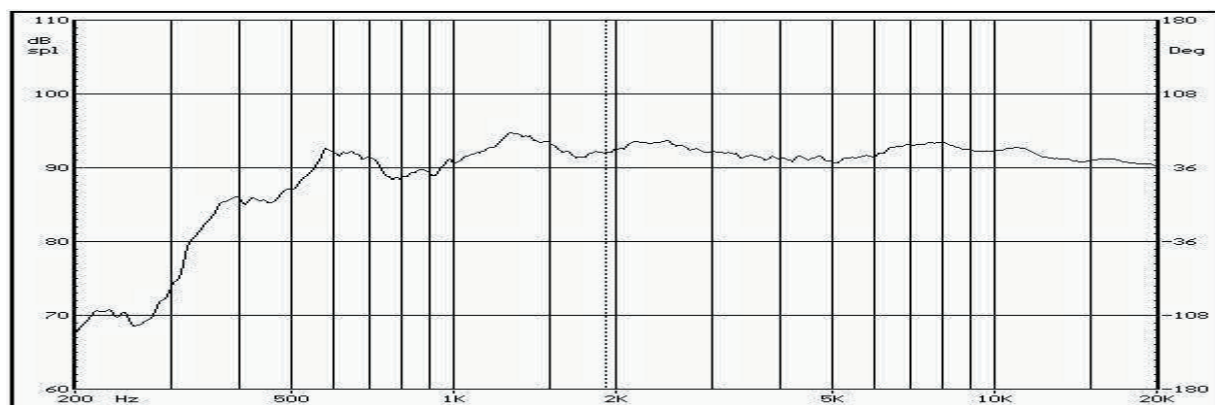

TECHNICAL FEATURES

- DOME: 27mm diameter silk dome.
- VOICE COIL: Pure copper on aluminum former (Ø 25 mm). Ferrofluid cooled.
- MAGNET: High quality Ferrite, magnetized by AD.
- BAFFLE: 91mm diameter, with a shape studied to increase the linearization.

Directly from home hi-end, this tweeter has a resonance frequency low enough to cross the bass frequency transducers without problems, building no compromise two way systems. Silk dome, ferrite magnet, high power handling are some of the features of this component, suggested in all those systems where quality rules, in particular over the scenic reconstruction of the musical reproduction.

Due to the continue research and development, these information are subject to change without notice.
Laboratorio Audio s.n.c. Via del Progresso 26/A Castegomberto (VI) AD audio development.

T 100 R

D:	28 mm
Re:	3 Ohm
Fs:	920 Hz
Qt:	0.62
Qm :	2.25
Bl:	1.22 N/A
Le:	0,35 mH
Freq-resp:	1.5-20 kHz
Pmax:	25 W 1,5 kHz
dB Spl:	90

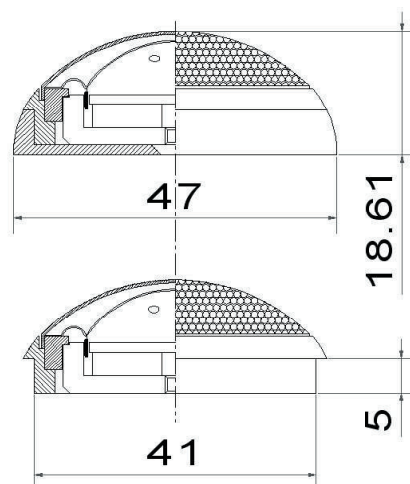

T100R IMPEDANCE

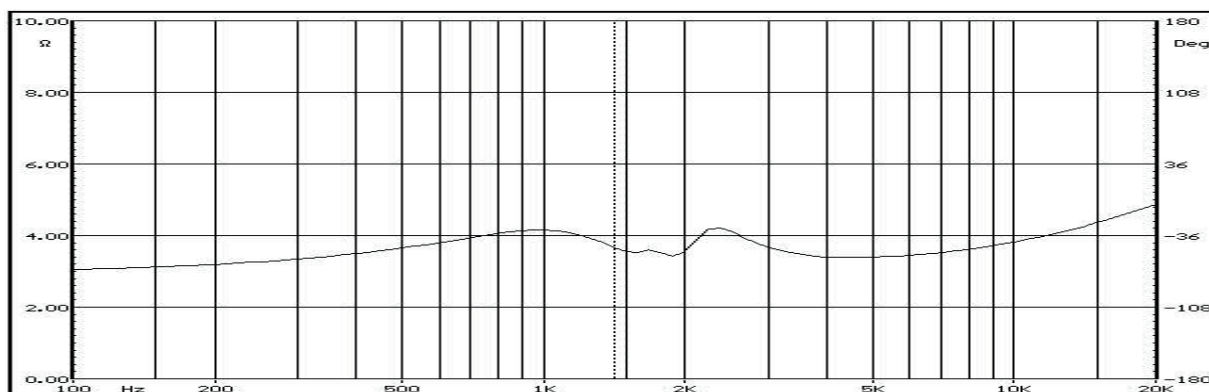

T100R FREQUENCY RESPONSE

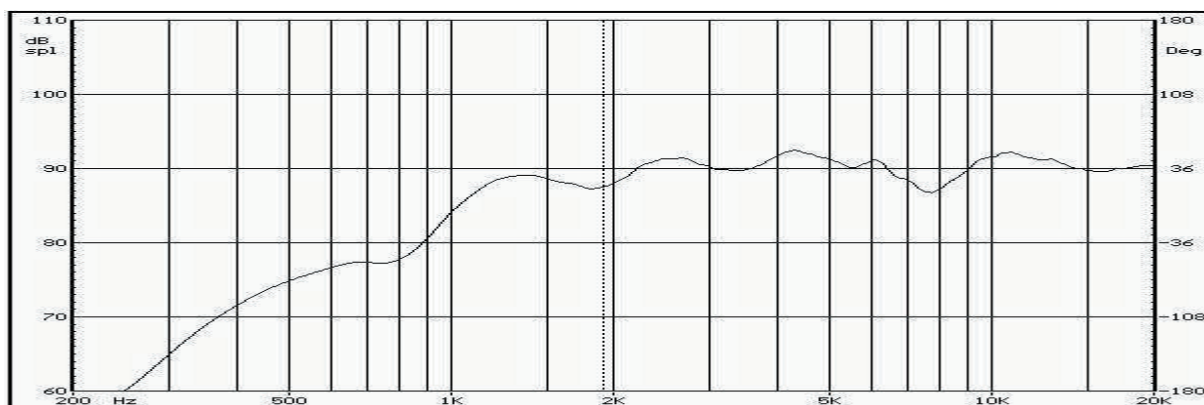

TECHNICAL FEATURES

- DOME: 28 mm diameter silk dome, ported and balanced on the suspension.
- VOICE COIL: Pure copper on aluminum former (Ø 25 mm). Ferrofluid cooled.
- MAGNETIC CIRCUITATION: High thermal stability Neodimium, magnetized with an internal procedure.
- MOUNTING SYSTEM: Tri-mount with adaptors, for external, internal or baffle usage.

Direct evolution of the T100, it differs for the superb working on the dome and the chamber beside it, which permits the T100 R to work tuned with a reflex port, extending the frequency response to 1.500 Hz, without increasing the third harmonic distortion.

Due to the continue research and development, these information are subject to change without notice.
Laboratorio Audio s.n.c. Via del Progresso 26/A Castelgomberto (VI) AD audio development.